



SITE PLAN

NTS



Assessment of:
**WORTHINGTON
PARK
ELEMENTARY**
500 Park Rd., Westerville, OH 43081

Sheet Name: SITE PLAN	
1544 Project No.	IO Drawn By
10/30/2015 Date	HG Checked by

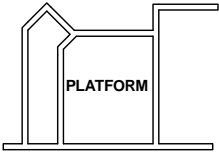
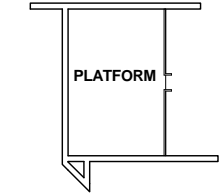

MEZZANINE AND PLATFORM PLANS

NTS

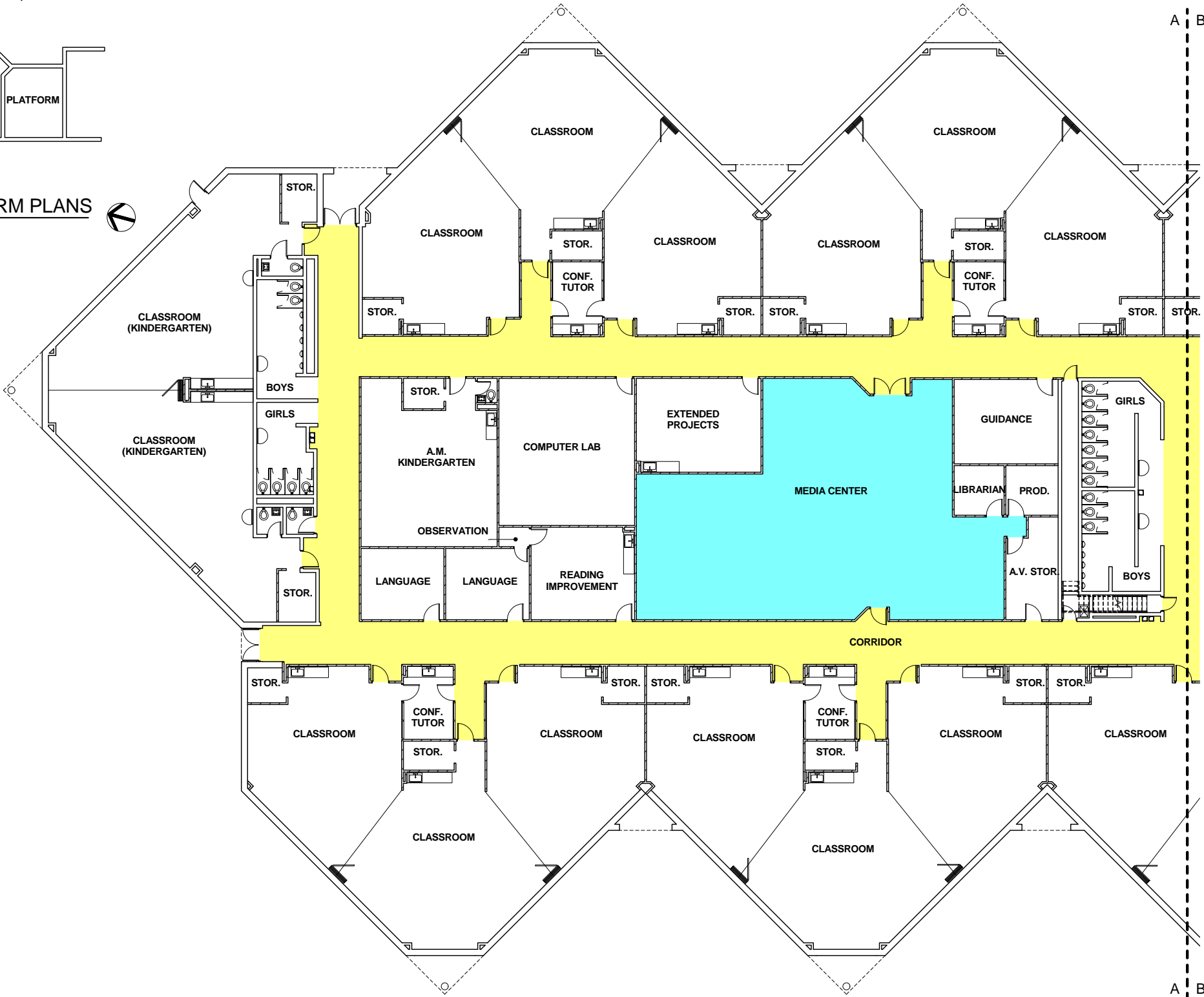

FIRST FLOOR PLAN - WEST

NTS



ADDITION	AUDITORIUM FIXED SEATING	CORRIDORS	AGRICULTURAL EDUCATION LAB	PRIMARY GYMNASIUM	MEDIA CENTER	VOCATIONAL SPACE	STUDENT DINING	KITCHEN	NATATORIUM	INDOOR TRACKS	BOARD OFFICES	OUTSIDE AGENCIES	AUXILIARY GYMNASIUM
ORIGINAL CONSTRUCTION (1988)	0	8,216	0	4,088	2,638	0	1,861	1,164	0	0	0	0	0
TOTAL	0	8,216	0	4,088	2,638	0	1,861	1,164	0	0	0	0	0

BUILDING COMPONENT LEGEND

- CORRIDOR
- KITCHEN
- MEDIA CENTER
- PRIMARY GYMNASIUM
- STUDENT DINING

KEY PLAN LEGEND

- 1988 ORIGINAL CONSTRUCTION (59,004 SF)

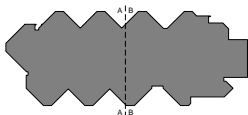

Assessment of:
**WORTHINGTON
PARK
ELEMENTARY**
500 Park Rd., Westerville, OH 43081

Sheet Name:
FIRST FLOOR PLAN - WEST

1544
Project No.
10/30/2015
Date

IO
Drawn By
HG
Checked by

2 OF 3

Drawing No.

ADDITION	AUDITORIUM FIXED SEATING	CORRIDORS	AGRICULTURAL EDUCATION LAB	PRIMARY GYMNASIUM	MEDIA CENTER	VOCATIONAL SPACE	STUDENT DINING	KITCHEN	NATATORIUM	INDOOR TRACKS	BOARD OFFICES	OUTSIDE AGENCIES	AUXILIARY GYMNASIUM
ORIGINAL CONSTRUCTION (1988)	0	8,216	0	4,088	2,638	0	1,861	1,164	0	0	0	0	0
TOTAL	0	8,216	0	4,088	2,638	0	1,861	1,164	0	0	0	0	0

BUILDING COMPONENT LEGEND

- CORRIDOR
- KITCHEN
- MEDIA CENTER
- PRIMARY GYMNASIUM
- STUDENT DINING

KEY PLAN LEGEND

- 1988 ORIGINAL CONSTRUCTION (59,004 SF)

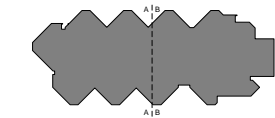

Assessment of:
**WORTHINGTON
PARK
ELEMENTARY**
500 Park Rd., Westerville, OH 43081

Sheet Name:
FIRST FLOOR PLAN - EAST

1544	IO
Project No.	Drawn By
10/30/2015	HG
Date	Checked by

3 OF 3

Drawing No.

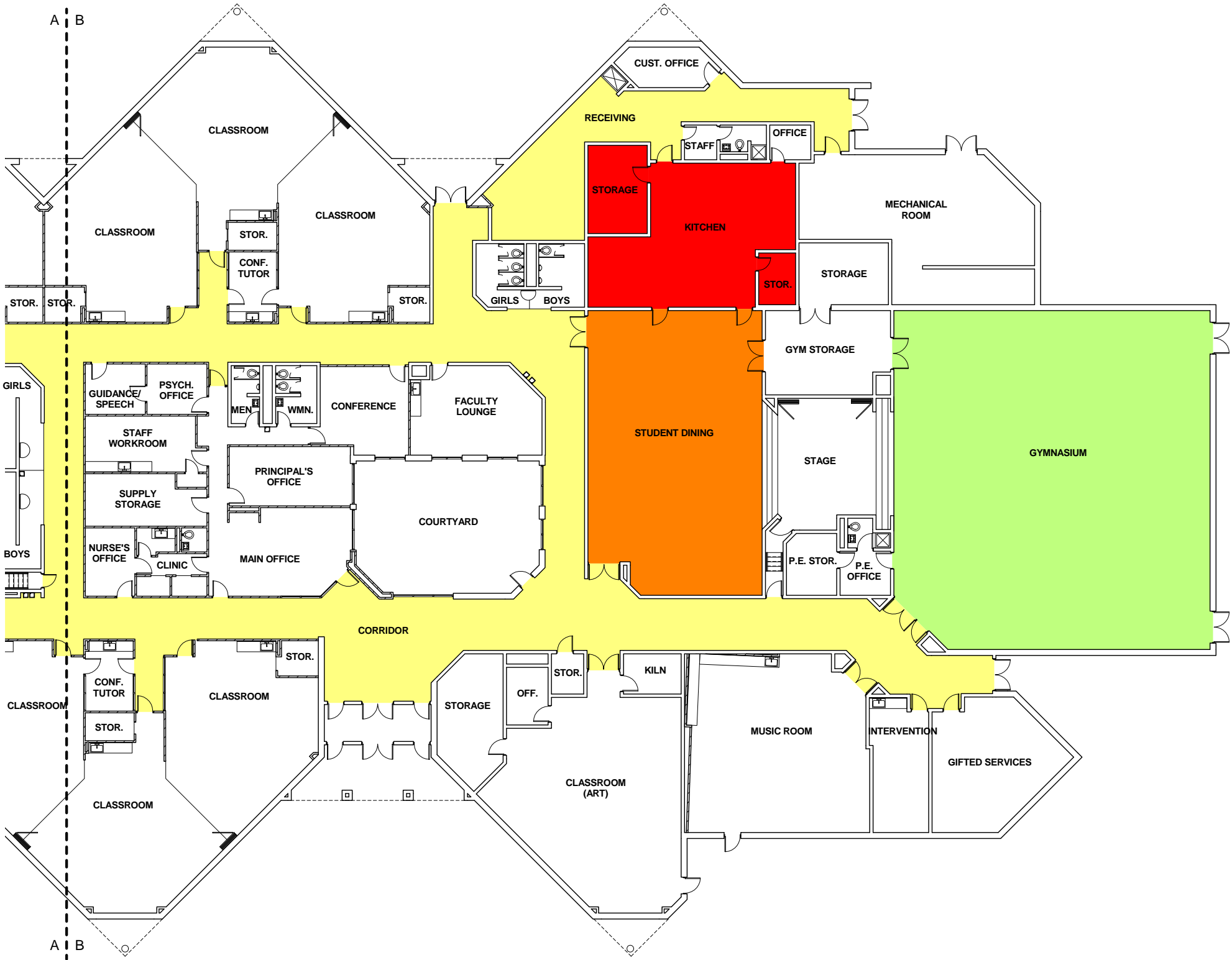

FIRST FLOOR PLAN - EAST

NTS

